



## Landcruising Lynx 1 (Release 2010)



Lynx verkörpert wie schon sein Name (engl. Luchs) andeutet, Eleganz und Leichtigkeit gepaart mit kraftvoller Robustheit und einer durchdachten Funktionalität. Hauptanwendungsspektrum des Lynx sind Slackline-Aufbauten aller Art bis max. 100m Länge / bzw. 10 kN Vorspannung. Mit dem Lynx kann die Slackline sehr schnell und komfortabel fixiert werden. Durch die Möglichkeit des handstraffen Nachziehens des Bandes lassen sich Spannsysteme, vor allem Flaschenzüge, sehr präzise im Aufbau verwenden. So wird das Statikseil mit maximaler Effizienz eingesetzt. Natürlich glänzt der Lynx auch mit geringer Bruchkraftreduktion.

Der Lynx kann in 2 Bauvarianten ausgeliefert werden, zusätzlich bieten wir eine optionale Zentrierhülse aus Alu für die Montage an Seilrollen an. Achtung - der Lynx passt an Singing Rock Twin (und baugleiche Derivate), Rock Exotica P21 D, Camp/Kong/LACD, SMC Micro aber nicht an die Faders Atlas bzw. SMC 3".

- Normalvariante mit montierter Expressschlinge für Befestigung in Schäkel oder Karabiner
- Rollenvariante mit montierter Zentrierhülse aber ohne Expressschlinge
- optionale Zentrierhülse aus druckfestem Aluminium (zur Umrüstung der Normalvariante)
  
- sehr kompaktes und optimiertes Design, passend für 25 mm oder 1 Inch Slacklines
- Quickpin Schnellverriegelung aus Edelstahl
- Edelstahlhülsen mit 2,5 mm Wandstärke und Außendurchmesser 14 mm
- 3 mm starke Seitenplatten aus Edelstahl
- Passschrauben mit durchgehendem Querschnitt
- selbsthemmende Muttern und Unterlegscheiben aus Edelstahl
- Gesamtgewicht der Normalversion mit Expressschlinge 240 g
- Einsatz bis maximal 10 kN Vorspannung
- getestete Bruchlast von z.B. White Magic 24 kN
- Design by Landcruising, Made in Saxony

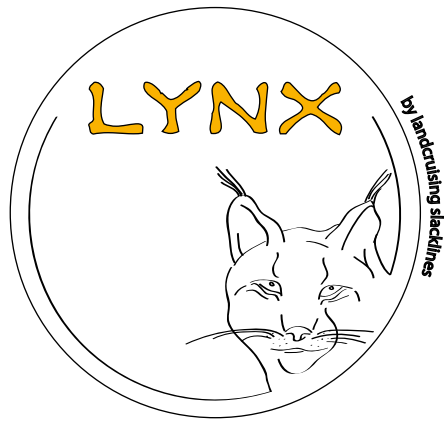

# Manual

for

## Lynx Slackline Anchor

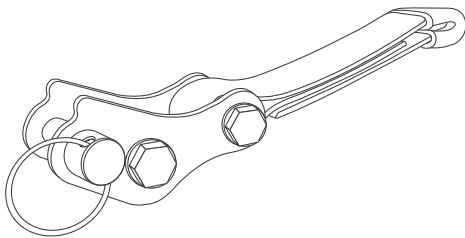

Rev. 1.1



### ! Caution !

Activities under the use of the Lynx are potentially dangerous.

You are responsible for your own actions and decisions.

Note the following before you use the Lynx:

- Read this manual completely
- Get familiar with the behaviour and limitations of the Lynx
- Step up carefully to higher pretensions and longer slackline lengths
- Understand the risks involved in the use of the Lynx, especially while longlining

### ! Load Limit (WLL) !

The Lynx should be used up to a maximum pretension of 10 kN

Breaking Strength of Lynx metal body > 30 kN  
Effective webbing breaking strength (e.g. new White Magic approx. 24 kN)

### 1. Intended use

The Landcruising Lynx is a slackline anchor tool for webbings of 25 mm (1 inch) width and 3.5 mm max. thickness.

Any other use is prohibited.

**The Lynx may not be used in the setup of highlines. The maximum height of a slackline anchored with the Lynx is 2 meter.**

The maximum tension in the slackline of 10 kN may not exceeded during setup and slacklining. The user is responsible for the control of the tension (simple middle sag - check as minimum)

The use of the Lynx and the thread of the webbing strictly following the method described in section 3 of this manual. Other webbing threading methods are prohibited.

### 2. Naming of parts

1. Side Plate, 2. Deviator, 3. Sling (alternative centrifrication sheath), 4. Screw Bolt, 5. Quickpin

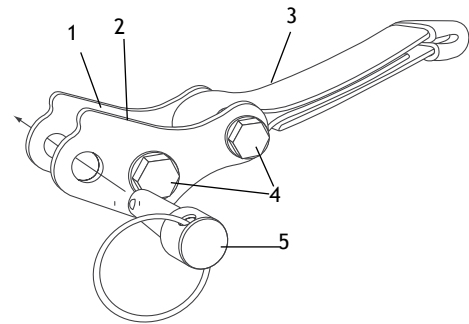

### 3. Threading the webbing

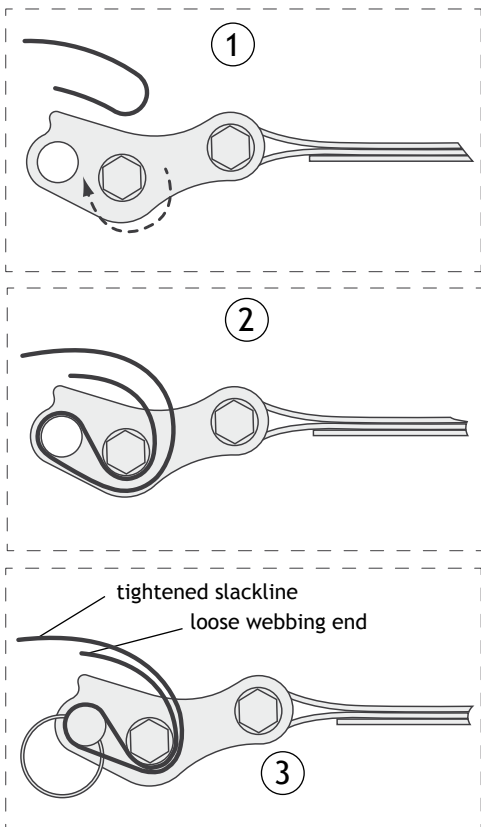

Pretightening - after locking the Quickpin, the loose webbing end can be pulled by hand while feeding the slackline with the other hand.

Take care of proper slackline centering!

### 4. Locking the Quickpin

The Quickpin must be securely locked after threading the slackline and before tightening!

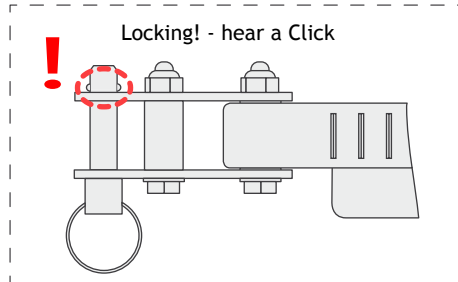
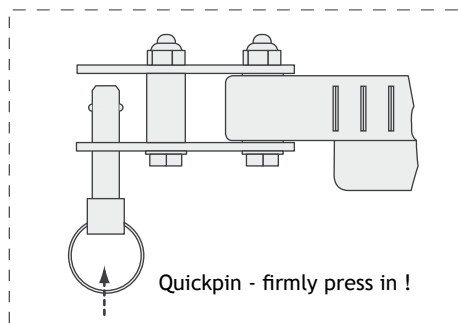

### 5. Note on setup options

The Lynx is delivered in 2 assembly options:

1. Variant with express sling for direct assembly to shackles - be aware of secure closure of the shackle pin.
2. Pulley variant with centering sheath instead of sling - the sheath centers the pulley - fasten the nut with 20 Nm.

### 6. Storage and removal

The Lynx needs dry storage - all parts except the screw bolts are made of corrosion resistant materials. Occasionally clean and grease the screw head to prevent rust.

**The screwing of the middle bolt with the deviator is prohibited.**

Tighten the rear bolt to 20 Nm while assembling the Lynx to a double pulley.

Caution! - loose nut or over tightening of the nut is prohibited

### 7. Disclaimer

Warranty:

The legal warranty is valid. Excluded are normal wear/tear, modifications/changes and damages caused by improper use.

We, as manufacturer and seller, are not responsible for injuries, consequential or/and incidental damages resulting from the use of the Lynx.

You assume full responsibility to all risks and property damage, personal injury or death which may arise in combination with improper use of the Lynx.

If you want not take this responsibility and risk, or if you not allowed to take full responsibility - don't use this product.